

FASCIA & SOFFIT INSTALLATION INSTRUCTIONS

Fascia

For Installations Without Soffit

- 1) Nail undersill trim or drip edge in place along the top of the fascia board.
- 2) Hook the bottom of the fascia panel under the bottom of the fascia board. Push the top edge into the undersill trim (as shown in illustration 1), or behind drip edge.
- 3) Secure the panel to the bottom of the fascia board with painted aluminum trim nails. Always nail underside of fascia as shown. Never face nail fascia. *Keep nails lined up with soffit V-grooves for best appearance. Nail every 24", but do not nail too tight. Nails should penetrate a minimum of 3/4" into nailing surface. Pre-drilling hole slightly larger than nail diameter is recommended.
- 4) When overlapping fascia panels, first cut a notch in the underlying panel. The notch should be 1-1/2" long. Slip the notched panel into the adjacent panel (see illus. 2).
- 5) **For Outside Corner Fascia:** Bend a 1" flange on the first fascia piece, 90 degrees around the corner. Cut overlapping fascia at 45 degree angle. Nail with painted aluminum trim nails (see illus. 3). **Inside Corner Fascia:** Use the same technique that was used for the outside corner fascia, but bend in the opposite direction to form an inside corner shape.

Face nailing can result in a wavy or buckled appearance during thermal expansion and contraction cycles. Always use a drip edge, gutter, or all-purpose trim to receive cut top edge of fascia. This provides a neat appearance and protects the substrate material from moisture.

For Installations That Include Soffit

Complete step 1 from above.

The fascia panel may need to be rip cut to fit over the fascia board and secure soffit. To determine width of the panel, measure from slot in undersill trim to bottom of F-channel or soffit face. Deduct 1/4" and cut (illus. 4).

OPTIONAL: Use a snap lock punch to create tabs 1/8" below cut edge. Punch tabs every 6", with tab raised on outside face of panel.

Install the panel by hooking the bottom of the fascia panel under the F-channel and pushing the top into the undersill trim or drip edge (shown in illus. 4).

Follow steps 3, 4, 5 above to complete installation.

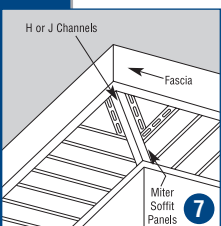
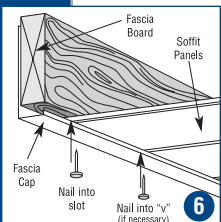
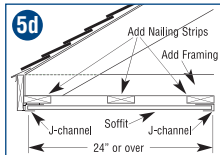
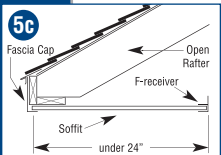
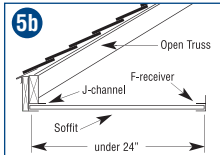
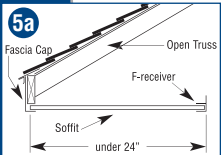
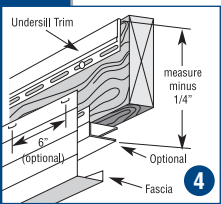
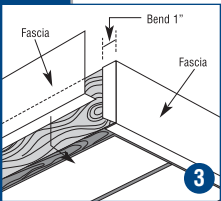
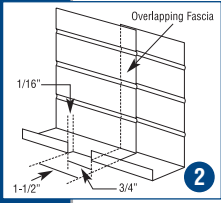
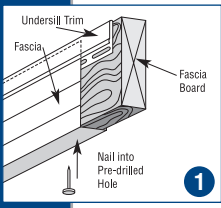

Soffit

Installations Over Open Eaves

- 1) Install receiving channels (F-receiver or J-channel).

There are several ways to install receiving channels for soffit. You can use accessories such as F-receiver or J-channel. Select a method that works most effectively with the construction techniques used to create the eave.

Examine the layouts 5a through 5d in the illustration to the left and find the one that most closely resembles the construction methods used on your particular project.

Recommended nailing for soffit is 16" o.c.; however, if the eave span is 24" or more, you must install nailing strips as shown in the last illustration 5d. In areas with high wind or in a location that's over 20 ft. above ground, do not exceed 12" on center.

Install the receiving channels following the details shown in illus. 5a-d. Nail channels every 16".

- 2) Measure from the wall to the fascia board. Then subtract 1/4" - 3/8" to allow for expansion. Once a soffit panel is face nailed, it will expand only in one direction. Be sure to leave space for the full expansion allowance in the receiving allowance.
- 3) Insert the panel into the channel on the wall, then into the panel at the fascia board. You may have to flex the panel slightly to insert it into the second channel. Make certain the panel is perpendicular to wall, then nail. Depending on the installation method you're using, you'll nail either to a nailing strip or to the fascia board.

If you're nailing to the fascia board, use small-headed nails. Drive nail through the nail flange and "v" groove. This is one of the rare instances face nailing is permissible. (See illustration 6)

If your using a nail strip, do not nail tightly - allow movement for expansion. Continue installation by locking and nailing panels. Make certain panels are fully locked along their entire length.

- 4) To turn a corner, measure from channel at wall corner to channel at corner of fascia board. Subtract 1/4" for expansion. Cut and install H-divide bar. If necessary, install nailing strips to provide backing for the lineal (shown in illus. 7). Miter the corner soffit panels and install as described in step 3.

- 5) To complete the installation, apply utility trim and fasten aluminum fascia cap with painted aluminum trim nails. If you must face nail fascia, drill holes for trim nails to allow for expansion and reduce denting of aluminum. Face nails are best positioned below the rolled brad in the shadowline. Use a nail punch to avoid hammer face contact with fascia.



a Euramax company

© 2009 Berger

BERGER BUILDING PRODUCTS, INC.
805 Pennsylvania Blvd. • Feasterville, PA 19053

(800) 523-8852

(215) 355-1200 • Fax: (215) 355-7738

www.bergerbuildingproducts.com